

SCHRADERGROUP

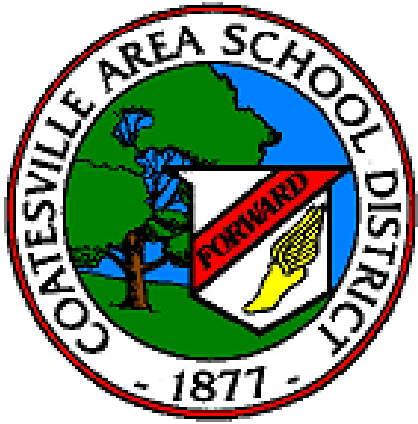

VISIONING WORKSHOP #3

For the:

Coatesville Area
School District

Kings Highway Elementary School

25 March 2019



SCHRADERGROUP

- 1 project information
- 2 last workshop results
- 3 concept history
- 4 proposed concept discussion
- 5 exterior taste test

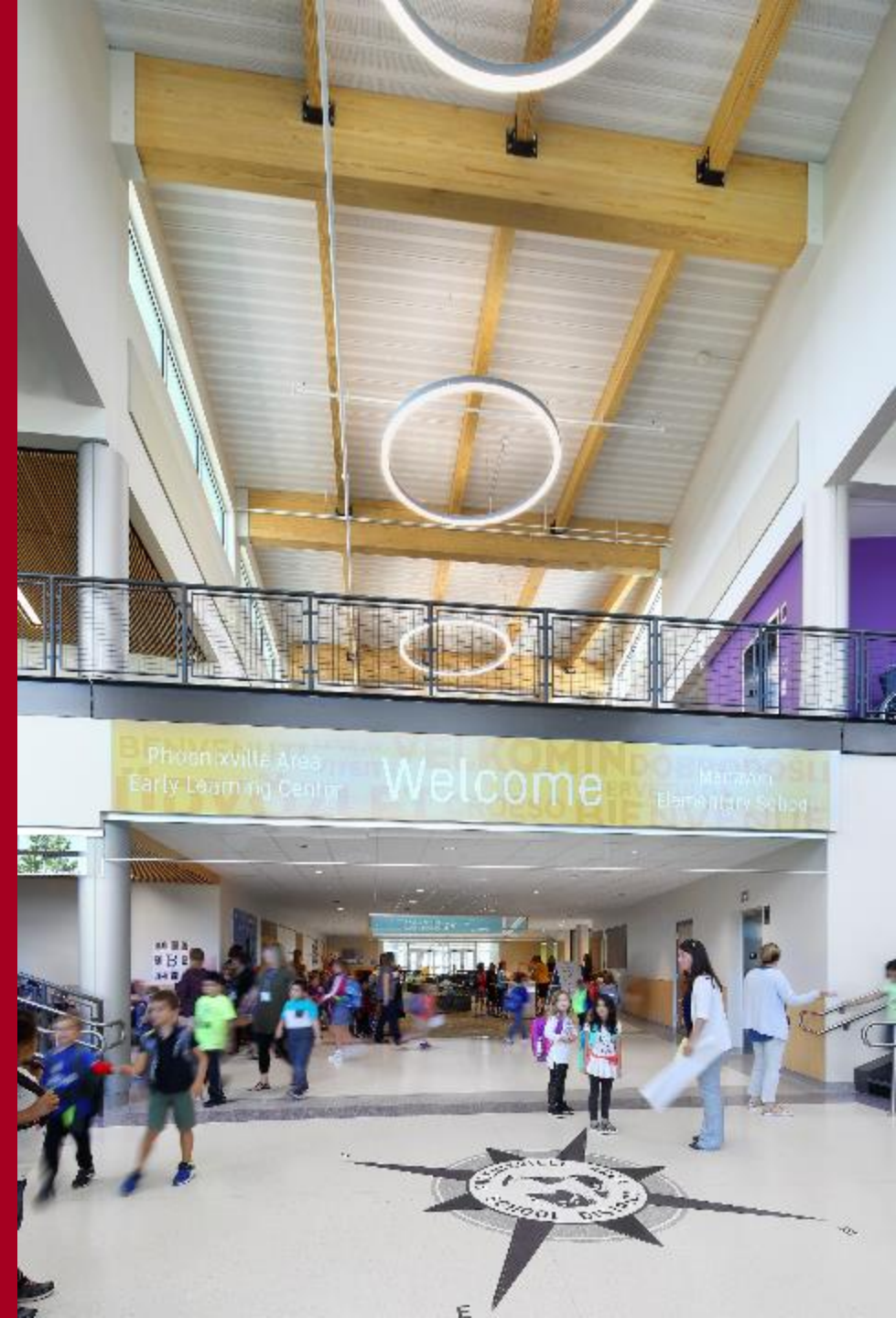

- 1 project information
- 2 last workshop results
- 3 concept history
- 4 proposed concept discussion
- 5 exterior taste test

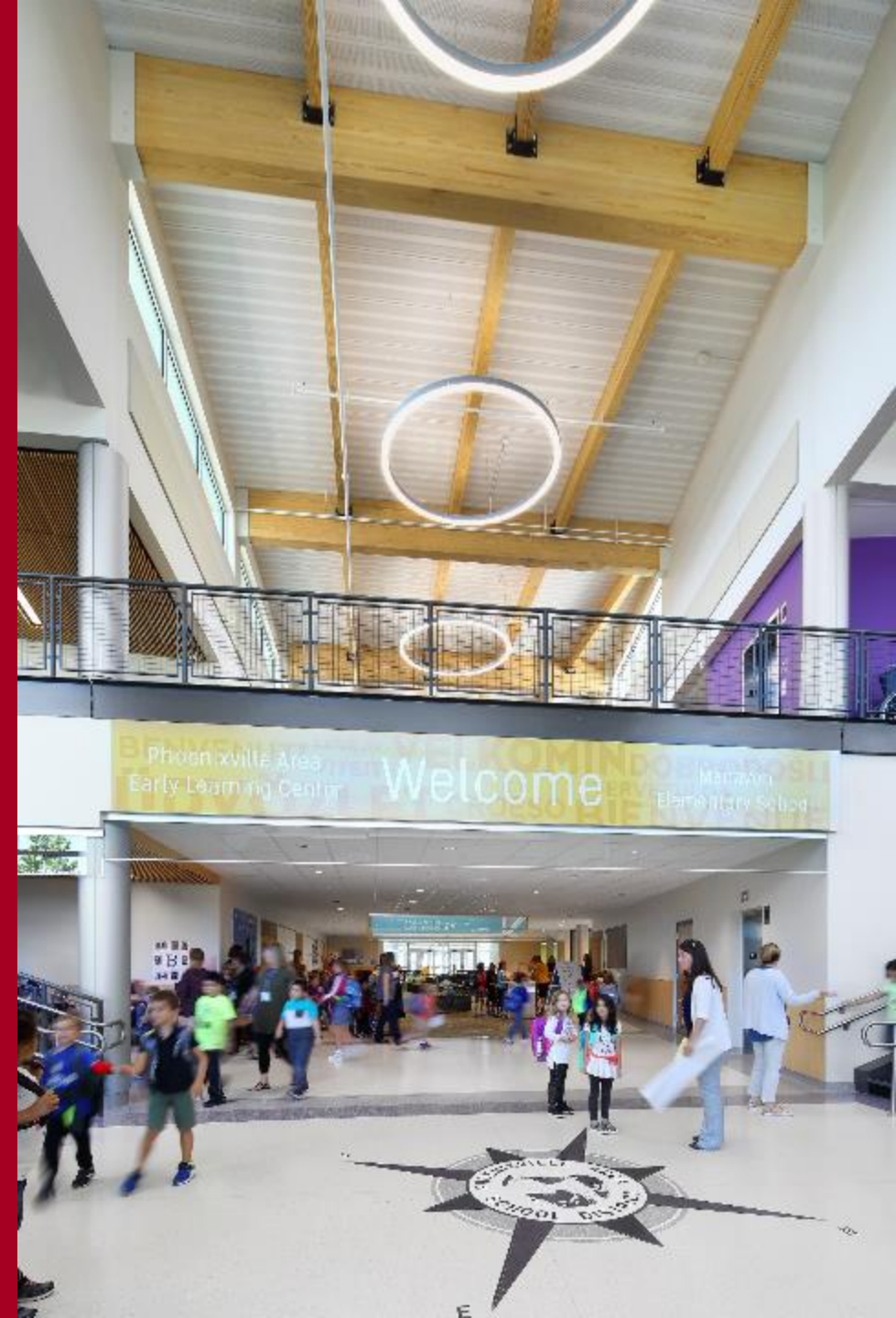

PROJECT INFORMATION

- proposed site
 - Acreage: approximately 24 acres +/-
 - Site particulars:
 - General plateau however sloping top to bottom on southeast side
 - Kings highway is a PennDOT roadway
 - District storage currently located in northwest portion of the site
 - Modular classrooms on the northeast corner of the facility
- facility:
 - Existing - 52,000 s.f. plus 4,000 s.f. modular
 - Proposed - 2-story proposed facility of 107,000 s.f.
- parking for:
 - zoning minimum or 150 spaces
- playing fields:
 - provide for general purpose fields and recreation fields
- other:
 - construct while existing building remains in operation

21st CENTURY LEARNING



LEARNING TYPE

- TRADITIONAL INSTRUCTION
- ONE-ON-ONE
- RESEARCH/ INVESTIGATE
- MAKE/ DEVELOP
- PRESENT/ REPORT OUT
- COMMUNITY/ INTERNAL COMMUNITY

SPACE TYPE

- MULTIPLE SIZED INSTRUCTIONAL SPACE
- SMALL GROUP WORK SPACES
- OPEN RESOURCE/ MEDIA CENTERS
- LARGE GROUP PROJECT AREAS
- PRESENTATION AREAS
- FULL-SIZED ACTIVITY AREAS

21st CENTURY LEARNING

A

MULTIPLE SIZED INSTRUCTIONAL SPACE

B

SMALL GROUP WORK SPACES

C

OPEN RESOURCE/ MEDIA CENTERS

D

LARGE GROUP PROJECT AREAS

E

PRESENTATION AREAS

F

FULL-SIZED ACTIVITY AREAS

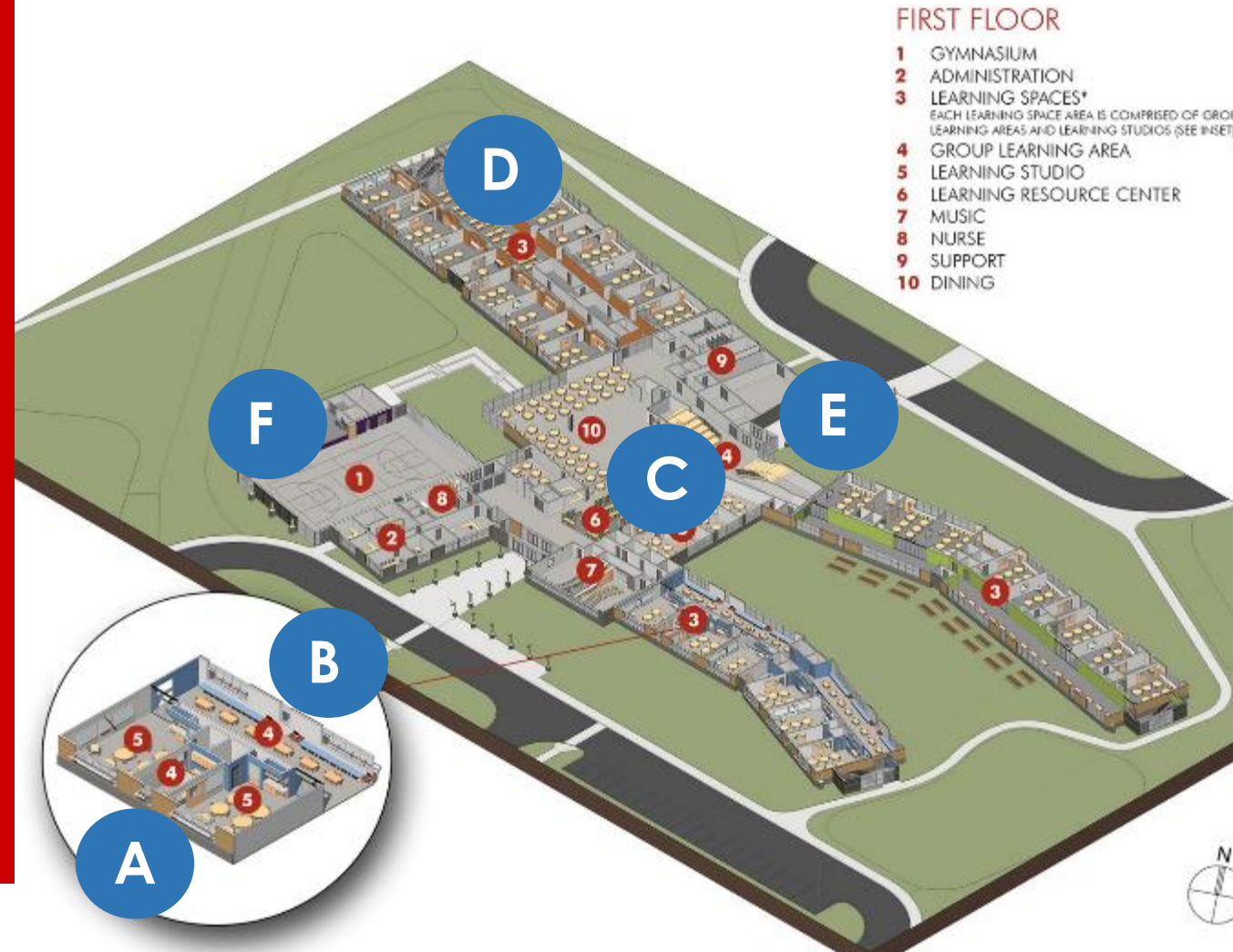

A

MULTIPLE SIZED INSTRUCTIONAL SPACES



B

SMALL GROUP WORK SPACES



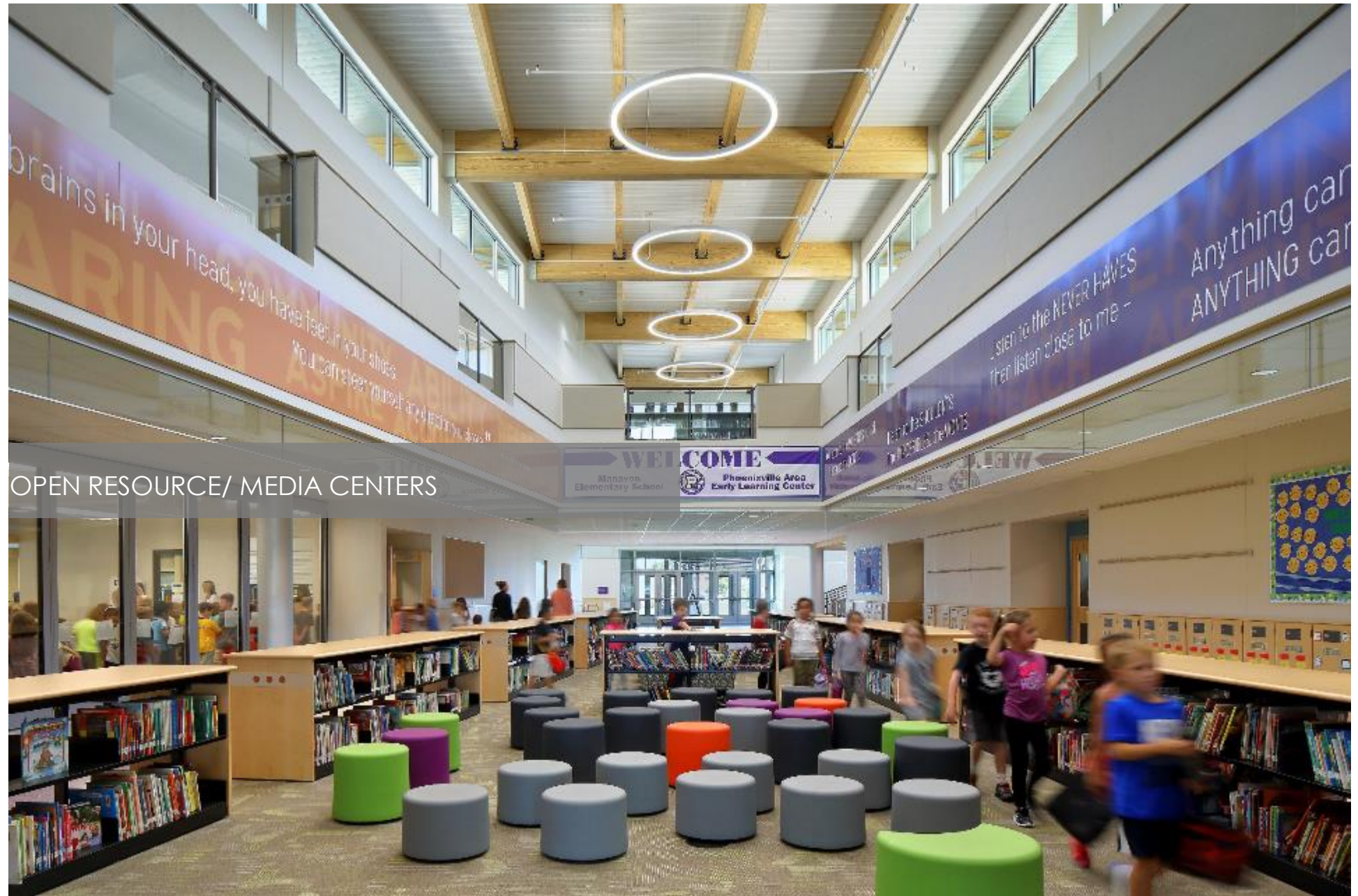

OPEN RESOURCE/ MEDIA CENTERS



LARGE GROUP PROJECT AREAS



PRESENTATION AREAS





FULL-SIZED ACTIVITY AREAS



- 1 project information
- 2 last workshop results
- 3 concept history
- 4 proposed concept discussion
- 5 exterior taste test

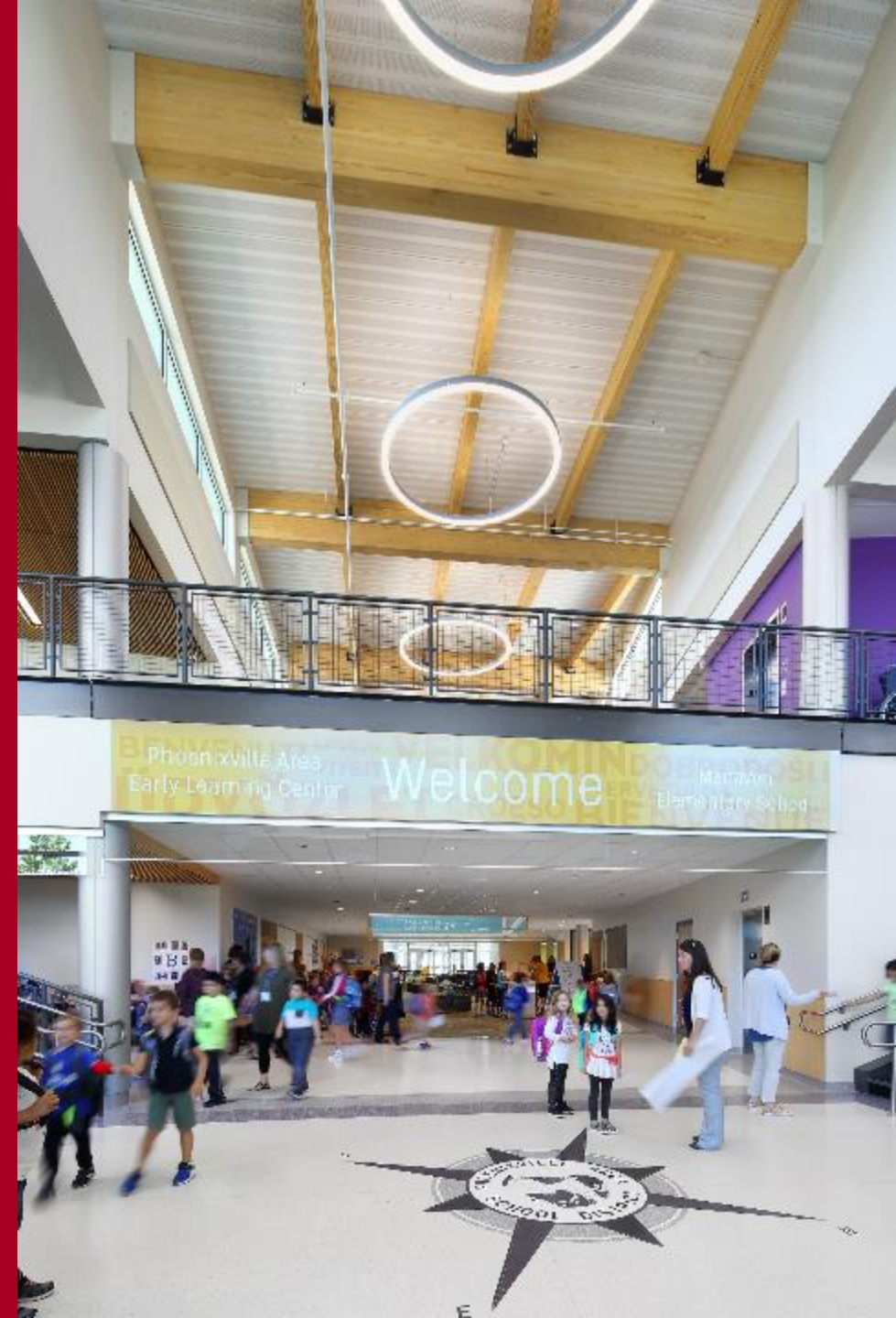

Public Meeting 01/15/19 - Results

- Like the stage between the dining and the gym
- ***Like toilets in classrooms***
- ***Prefer cubbies in classrooms***
- Prefer the partially closed media center like UMASD
- Provide water fountains in classrooms and sinks in classrooms
- Need conf rooms
- IPCs per grade level/cluster
- Prefer integration of art/music/tech “STEAM”
- Provide grade level storage outside of CRs
- Provide moveable bookcases

Public Meeting 01/15/19 – Results cont.

- Provide whole teaching walls - magnetic
- Like windows/natural light
- Like wide stairways/Learning stairs
- STEAM room should have storage behind the teaching wall
- Like outdoor learning spaces
- Like the small space/cozy reading nooks
- Provide for security
- Is there a possibility of LEED pursuit/sustainability?
- Do not use carpet
- Provide a sensory room



SCHRADERGROUP

PEALE

"If you stopped yourself every time you said
'I have to' and changed it to 'I get to'
it might change your entire experience."
— MARTIN LUTHER KING, JR.

"Try to be a rainbow
in someone's cloud."
— MARY A. HOLT

SCHRADERGROUP



SCHRADERGROUP



SCHRADERGROUP



SCHRADERGROUP



SCHRADERGROUP



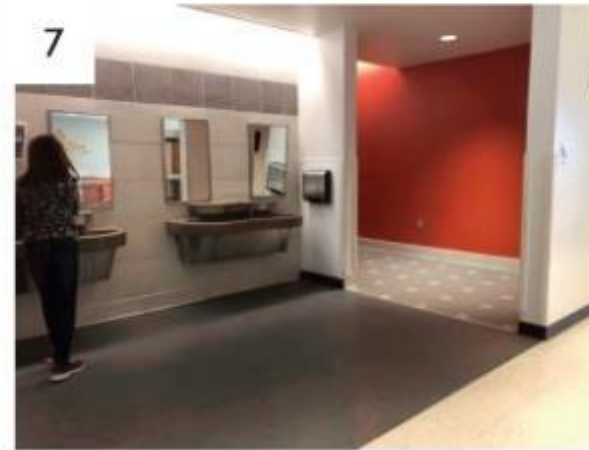

- 1 project information
- 2 last workshop results
- 3 concept history
- 4 proposed concept discussion
- 5 exterior taste test



**KING'S HIGHWAY
ELEMENTARY SCHOOL**
Existing site



SCHRADERGROUP

KING'S HIGHWAY ELEMENTARY SCHOOL Concept 1

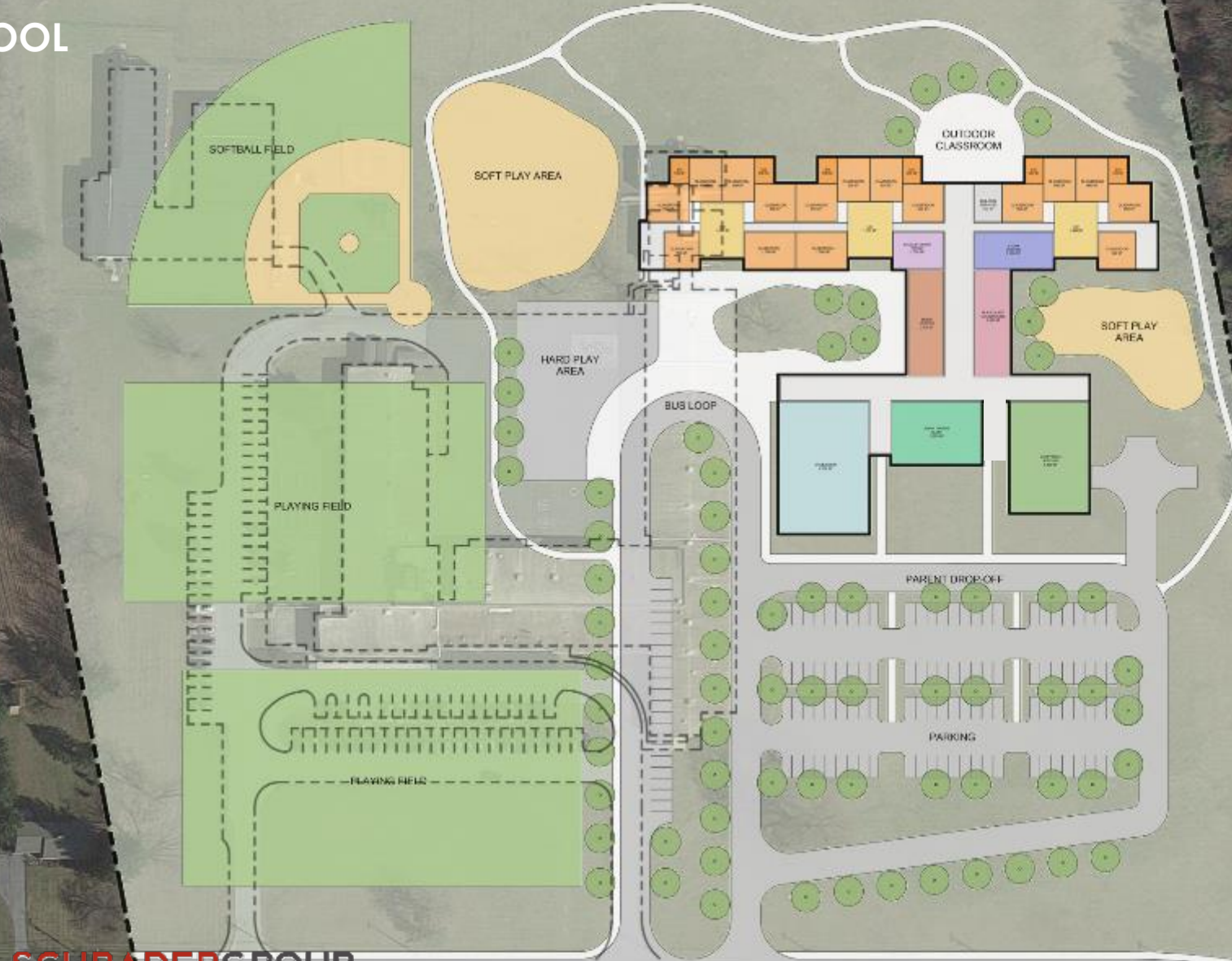

SCHRADERGROUP

KING'S HIGHWAY ELEMENTARY SCHOOL Concept 2



KING'S HIGHWAY ELEMENTARY SCHOOL Concept 3

SCHRADERGROUP



KING'S HIGHWAY
ELEMENTARY SCHOOL
Concept 4



**KING'S HIGHWAY
ELEMENTARY SCHOOL
Concept 5**



**KING'S HIGHWAY
ELEMENTARY SCHOOL
Concept 6**



SCHRADER GROUP

**KING'S HIGHWAY
ELEMENTARY SCHOOL**
Concept 7



- 1 project information
- 2 last workshop results
- 3 concept history
- 4 proposed concept discussion
- 5 exterior taste test



KING'S HIGHWAY ELEMENTARY SCHOOL Concept 6



KING'S HIGHWAY ELEMENTARY SCHOOL Concept 6 First Floor Plan



KING'S HIGHWAY ELEMENTARY SCHOOL

Concept 6

Second Floor Plan



KING'S HIGHWAY
ELEMENTARY SCHOOL
Detail Areas

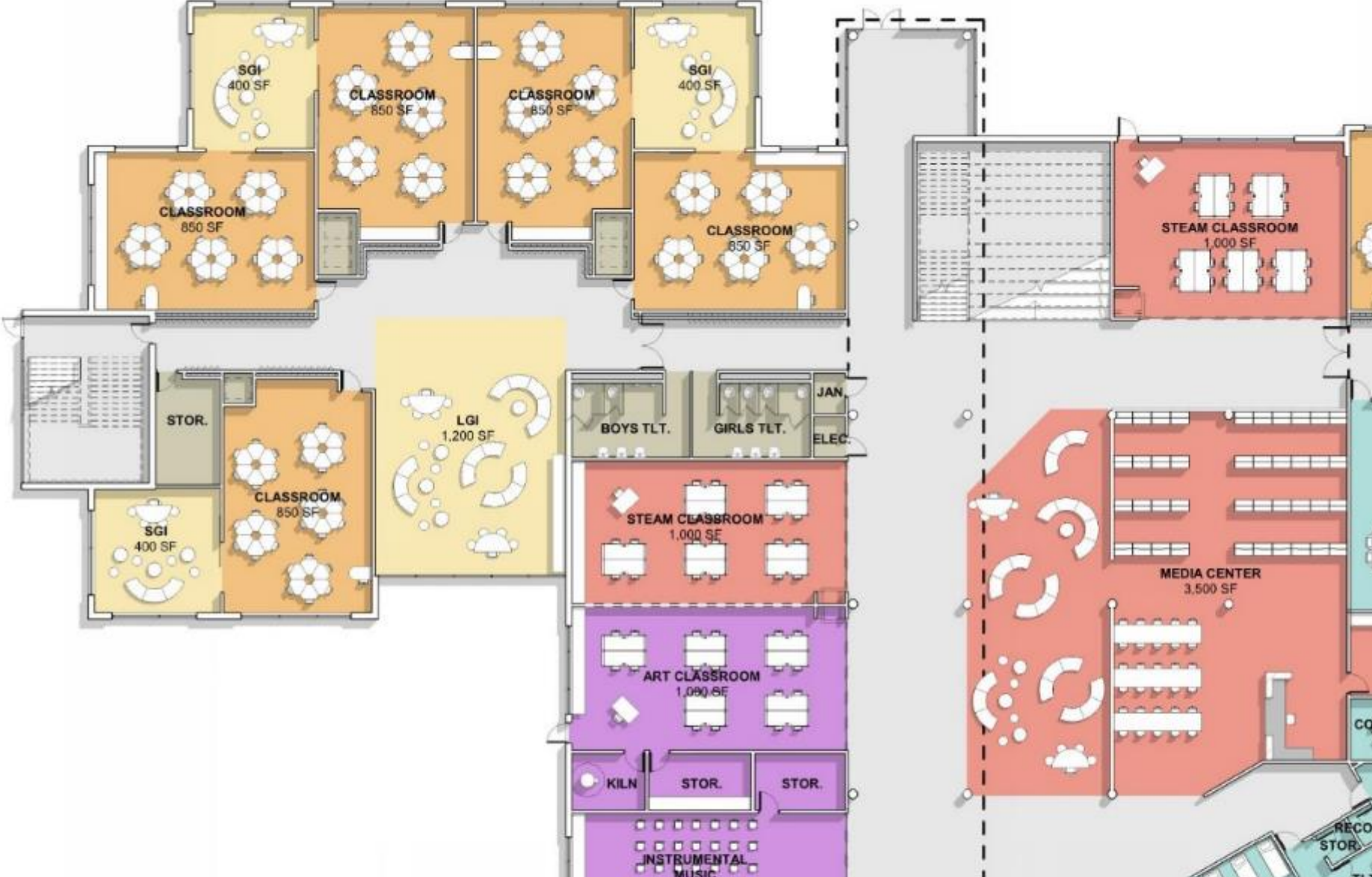

KING'S HIGHWAY ELEMENTARY SCHOOL

Detail Areas

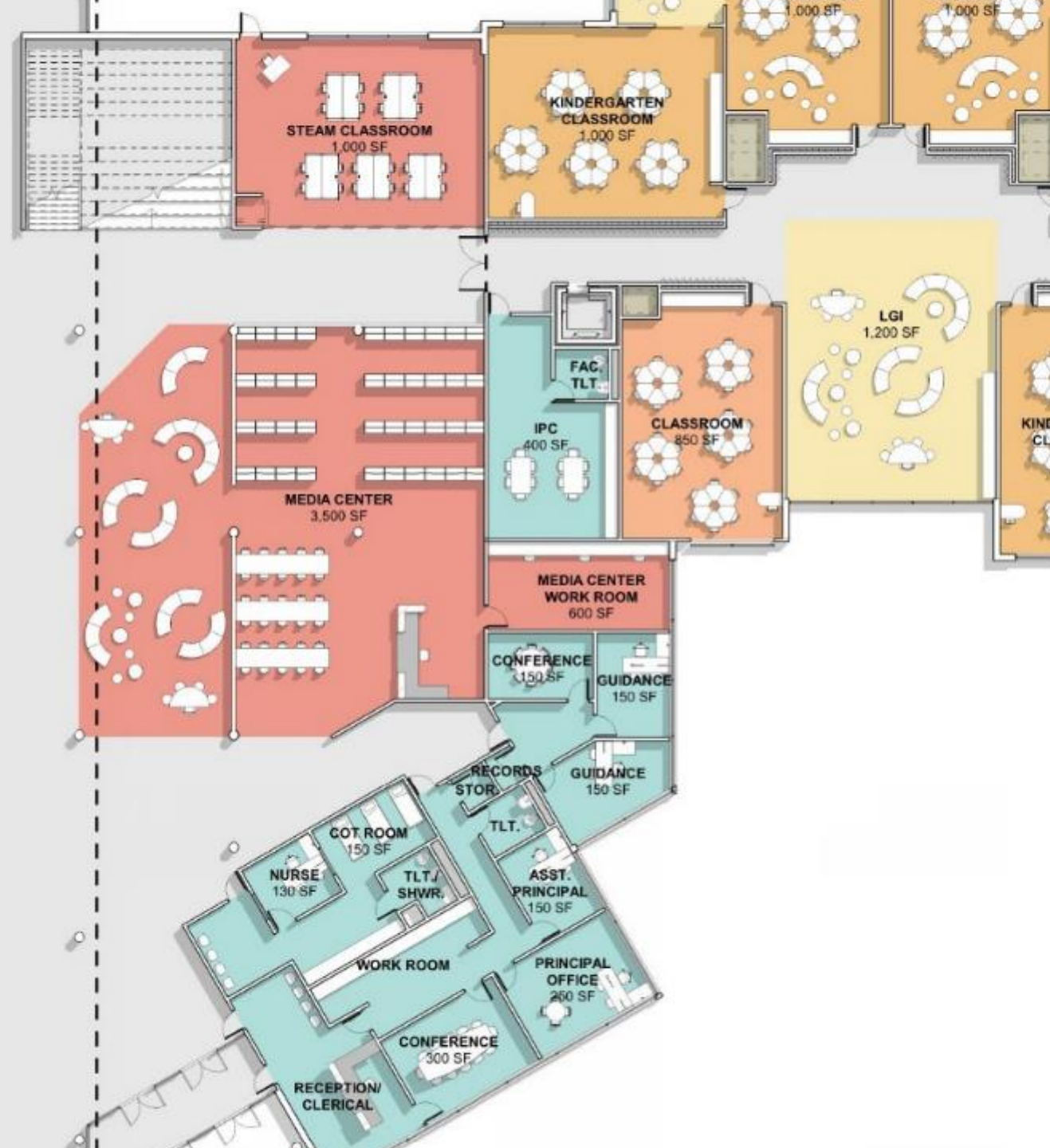

KING'S HIGHWAY ELEMENTARY SCHOOL Detail Areas



- 1 project information
- 2 last workshop results
- 3 concept history
- 4 proposed concept discussion
- 5 exterior taste test



17



Love - 2
Like - 3

24



Love - 0
Like - 5

11



Love - 2
Like - 1

15



Love - 1
Like - 3

2



Love - 1
Like - 2

21



Love - 1
Like - 2

16



Love - 0
Like - 3

30



Love - 0
Like - 3

KING'S HIGHWAY
ELEMENTARY SCHOOL
Exterior



SCHRADERGROUP